



13, Burfield Court Handcross Road, Luton, Bedfordshire, LU2 8JY
£900 Per month



- EXCLUSIVE TO PR PROPERTY LETTINGS
- CLOSE TO AIRPORT
- GOOD CONDITION
- MUST BE VIEWED
- LUXURY MODERN FINISH
- GOOD TRANSPORT LINKS
- CLOSE TO SHOPS AND SUPER MARKET
- PARKING ON SITE
- AVAILABLE APRIL 2026
- ONE BEDROOM

** Exclusive to PR Property ** This luxury one-bedroom apartment on Handcross Road, Luton, combines contemporary style with practical living. The property boasts a modern finish throughout, featuring a bright open-plan lounge and kitchen area designed for comfortable living and entertaining. The bedroom offers ample space and is complemented by a sleek bathroom. Available parking ensures ease and security, a valuable addition in this desirable area. Positioned close to essential amenities and transport links, this apartment is ideal for those looking for a well-appointed home in a convenient location.

ENTRANCE HALL

LIVING ROOM 10'1" X 6'7" (3.08M X 2.00M)

KITCHEN 6'8" X 5'2" (2.04M X 1.58M)

BEDROOM 1 10'4" X 7'6" (3.14M X 2.29M)

BATHROOM

Ground Floor
Approx. 30.7 sq. metres (330.1 sq. feet)

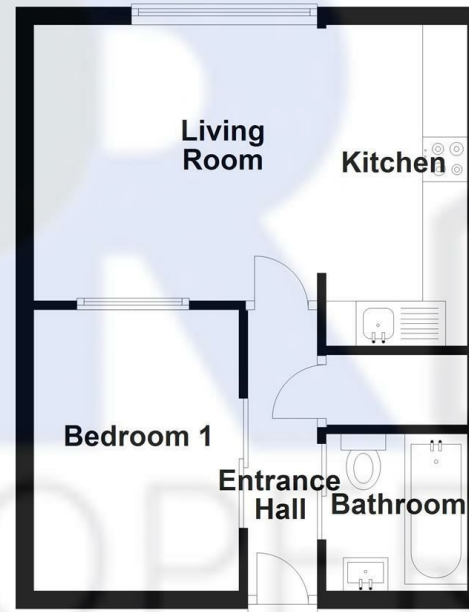

Total area: approx. 30.7 sq. metres (330.1 sq. feet)

Energy Efficiency Rating		Current	Potential
Very energy efficient - lower running costs			
(92 plus)	A		
(81-91)	B		
(69-80)	C		78
(55-68)	D	58	
(39-54)	E		
(21-38)	F		
(1-20)	G		
Not energy efficient - higher running costs			
England & Wales		EU Directive 2002/91/EC	